

# SMART SWITCH

OPT-WIFI



## USER GUIDE

Enhance your Fire Feature control with The Outdoor Plus Smart Switch. This Wi-Fi enabled switch allows seamless remote operation via your smartphone or voice assistants, offering convenience and customization.

### PRODUCT DESCRIPTION



#### Rocker

Press top button to turn ON.

Press bottom button to turn OFF.

#### Status LED

Lights up when off for easy location.

Shows device status.

Advanced settings available in the App.

### GET THE APP

Download the **My Leviton** App on the App Store or Google Play.



### WORKS WITH SMART HOME PRODUCTS

Control your Fire Feature hands-free with Alexa, Google Home, SmartThings, and more.



## **TABLE OF CONTENTS**

Safety	3
Specifications	4
Fire Feature Wiring Diagram	5
Installation	6
Testing & Installation	8
Device Setup	9
Diagnostic LED	11
Setup Mode & Factory Reset	12
Troubleshooting	13

# SPECIFICATIONS

**NOTE:** General purpose loads up to 15 amps, for specific ratings see the chart below.

<b>RATINGS</b>	
General Use	15A, 120VAC, 60Hz
LED / CFL / Electronic Ballast	5A
Incandescent / Halogen	1500W
Magnetic Ballast	15A
Motor	3/4 HP
Operating Temp	0°C - 40°C (32°F - 104°F)
Operating Humidity	0-90% non-condensing
<b>STANDARDS AND COMPLIANCE</b>	
Complies with UL 917, CSA C22.2 No. 177-13	
CSA Listed for USA and Canada	
NOM Certified	
Wi-Fi Certified™	
Complies with FCC Part 15, Class B	

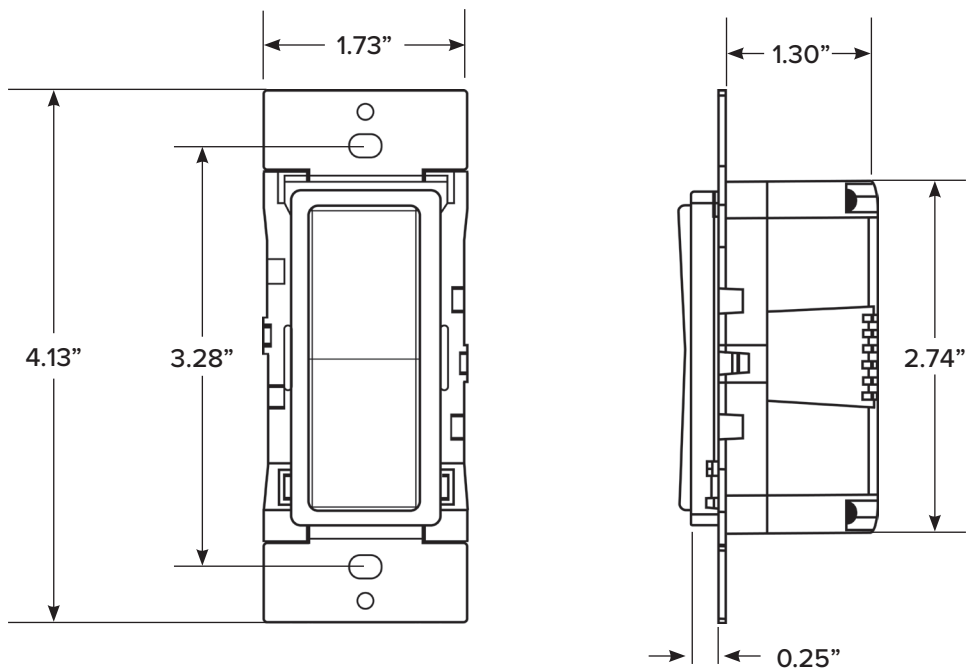

## SAFETY

---

### WARNING:

- **To avoid Fire, Shock, or Death, turn off power at circuit breaker** or fuse and test that power is off before wiring.
- **To avoid Fire, Personal Injury, or Property Damage, do not** install to control a receptacle.
- This product is to be installed and/or used in accordance with local electrical codes and regulations.
- Save these instructions for future reference. If you are unsure about any part of these instructions, The Outdoor Plus highly recommends consulting a qualified electrician.

### CAUTION:

- Maximum wire length from switch to all installed companion devices cannot exceed 300ft (90m).
- Recommended minimum wall box depth is 2-3/4”.
- Use this switch with copper or copper clad wire only.

## SPECIFICATIONS

---

PART NUMBER OPT-WIFI

NETWORK	
Wi-Fi	802.11 b/g/n networks - 2.4GHz only
Security	WPA, WPA2, or WPA3 security, or open
Bluetooth	v5.0
MY LEVITON APP	
IOS	Version 12.0 or later
Android	Version 8.0 or later



### WARNING

Do not use your switch with metal wall plates or aluminum wire.

# FIRE FEATURE WIRING DIAGRAM

## NOTE:

The Outdoor Plus ships the Wi-Fi Smart Switch pre-wired in a durable, weatherproof box, ensuring seamless compatibility with your Fire Feature. This pre-assembled setup makes installation quick and hassle-free. To continue with the pre-assembled configuration, skip to page 9 for Device Setup.

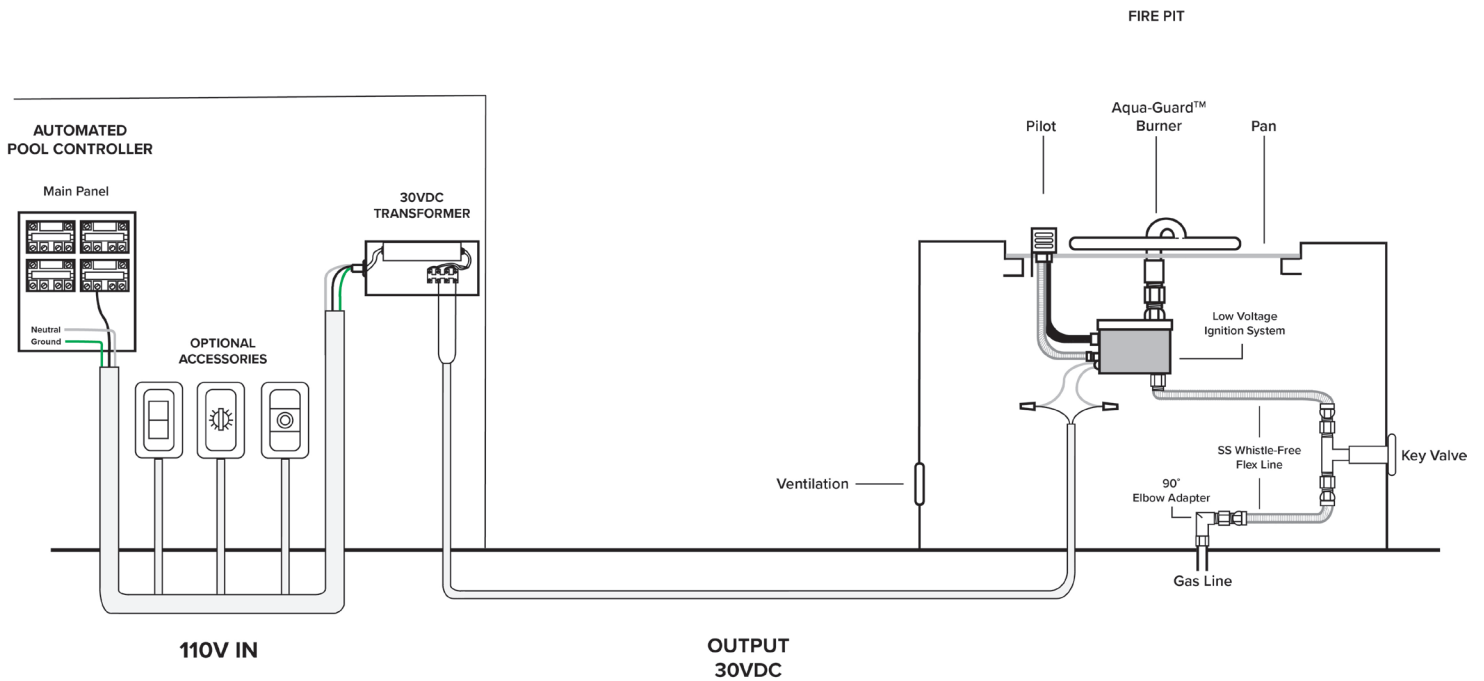

## WARNING

Do not use your switch with metal wall plates or aluminum wire.

# INSTALLATION



## WARNING

To avoid Fire, Shock, or Death, turn off power at the circuit.

### BEFORE YOU INSTALL:

- Installation requires electrical knowledge. If you are unsure of any steps, consult an electrician.
- A 2.4GHz Wi-Fi network with high speed internet.
- An IOS (12.0 or later) or Android (8.0 or later) mobile device. Make sure Wi-Fi and Bluetooth are enabled on your mobile device.
- A My Leviton cloud account (set up through the My Leviton app).

### IDENTIFY YOUR WIRES (Check Your Wall Box):

1. Remove wall plate and disconnect existing switch.
2. Restore power. Carefully test wires with voltage tester to find the line (hot) wire.
3. **TURN OFF POWER AT THE CIRCUIT BREAKER.**
4. Mark the wires as shown below. Please note neutral wires are required to operate this device.

**NOTE:** Neutral wires are typically white and will be found bundled inside the electrical box.

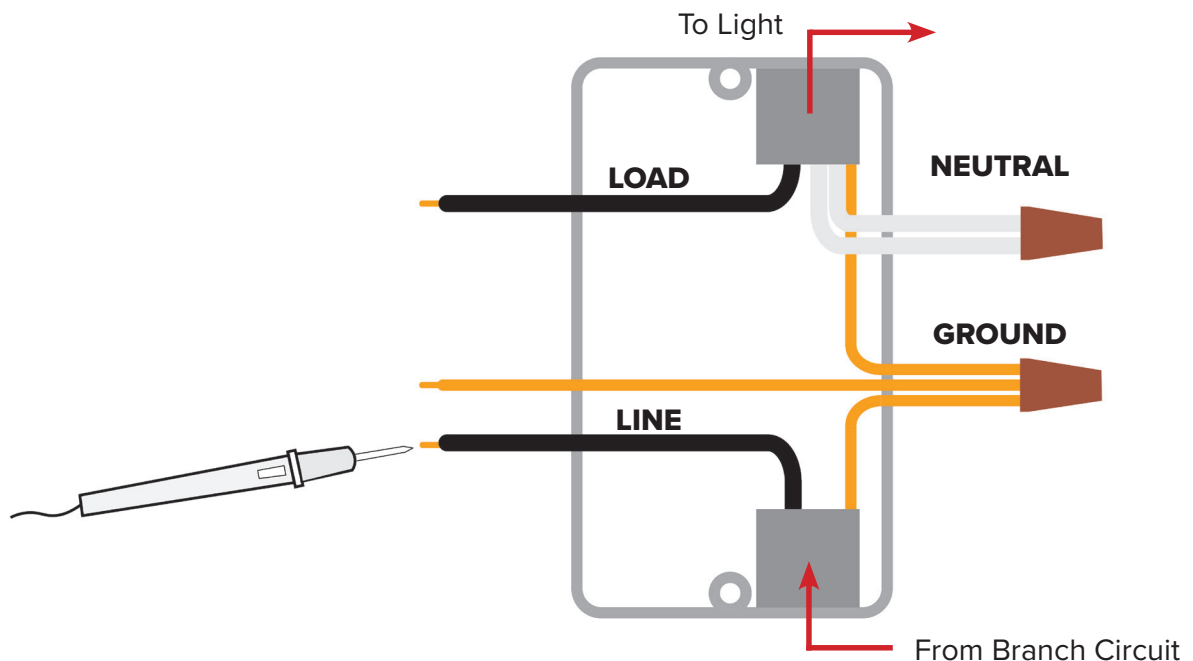

**NOTE:** If your wall box looks different, contact a qualified electrician.

## INSTALLATION

---

### WIRE YOUR SWITCH (Single Pole Installation):

1. Work on only one connection at a time.
2. Connect wires as shown using the included wire connectors.

#### NOTE:

- Neutral connection is required.
- The YELLOW/RED traveler wire is only used in 3-way applications; remember to put a wire connector on the YELLOW/RED traveler wire even if not in use.

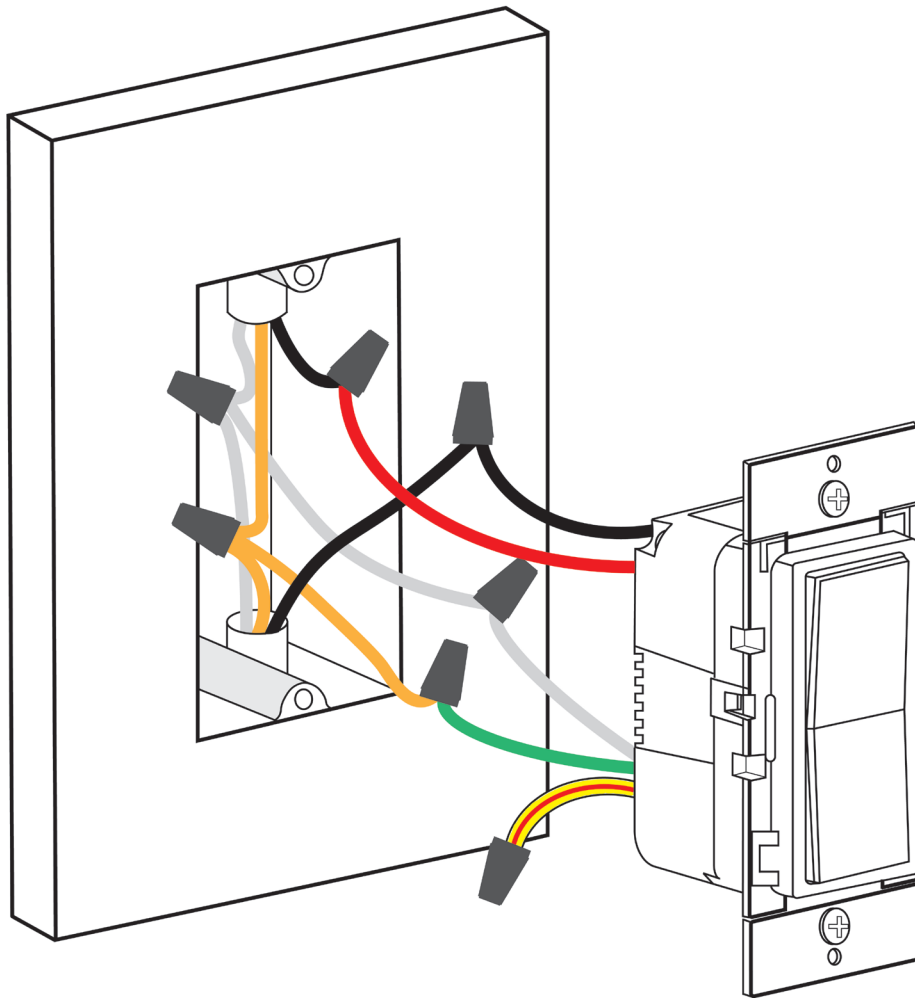

**NOTE:** If your wall box contains a different wiring configuration, contact a qualified electrician.

## TESTING & INSTALLATION

---

### TEST:

1. Restore power. Status LED should flash **Green**, indicating that your switch is ready to be connected.
2. After you have confirmed that your switch is receiving power, turn the power back off at the circuit breaker prior to completing the installation.
3. Gently push all wires back into the wall box, then screw the switch to the box.
4. Snap on the wall plate and restore power.

### NOTE:

- Once power is restored, the status LED will blink **Green** indicating your device is in setup mode. See page 11 if your Status LED is not blinking **Green**.

## DEVICE SETUP

---

### DEVICE SETUP:

- The Wi-Fi Smart Switch can be connected to the My Leviton service, Apple HomeKit, or both.
- For voice control with Amazon Alexa or Google Assistant, you will need to setup your device with My Leviton first.
- For voice control with Siri, you will need to connect your device to Apple HomeKit. See page 10 for instructions on how to add your device.

### ADD YOUR DEVICE TO MY LEVITON:

1. Make sure your device is in **setup mode** (status LED should be blinking **Green**). If the status LED is **not** blinking **Green**, see page 12 for instructions on how to put your device in setup mode.
2. Launch the My Leviton App.
3. Log in or choose “Sign Up” to create an account.
4. Follow the instructions on the screen.
5. Once logged in tap the “+” in the bottom menu and select “Add Device”.
6. Follow the in-app instructions to add your device and connect it to your home Wi-Fi network.

### TEST APP CONTROL:

1. Open the My Leviton App.
2. Tap “Switch” icon to turn ON/OFF your Fire Feature.

### NOTE:

- Scheduling, remote control, and auto-shutoff can be controlled within the app.

## DEVICE SETUP

---

### CONNECT SMART HOME PRODUCTS (Optional):



1. Tap menu in lower right corner.
2. Tap “Integrations” then locate and select the desired service. Follow instructions to continue.

### CONNECT TO APPLE HOMEKIT (Optional):



**NOTE:** Skip step 1 if your device is already enrolled to My Leviton and on your Wi-Fi network.

1. Make sure the device is in setup mode (status LED should be blinking **Green**). If the status LED is not blinking **Green**, see page 12 for instructions on how to put the device into setup mode.
2. Using your IOS Device, open the Apple Home App and select “Add Accessory.”
3. Make sure your Smart Switch is model **D215S**. Locate and scan the HomeKit setup code on the device by removing the faceplate.
4. Follow the instructions in the Apple Home App.
5. Once the device is set up, you will be able to voice control your Smart Switch with Siri.

### NOTE:

- Scheduling, remote control, and auto-shutoff can be controlled within the app.

## DIAGNOSTIC LED

---

- If your device is not connecting to the My Leviton App, the status LED can be used as a diagnostic tool. Press the top rocker for at least 2 seconds (but no more than 7 seconds) then release. The status LED will blink a diagnostic code for 2 seconds.

COLOR	STATUS
Amber	Not connected to Wi-Fi.
Red	Connected to Wi-Fi, but not able to connect to the My Leviton cloud.
Green/Amber Alternating	Connected to Wi-Fi and My Leviton cloud but unable to set the time from the internet.
Green	Connected to Wi-Fi and My Leviton cloud is working properly.

### STATUS LED:

COLOR	ACTIVITY	STATUS
Green	Green	In setup mode and ready to be added to a Wi-Fi network.
Green	Slow Blink	Connecting to a Wi-Fi network on power up.
Green or Off	Solid	Normal operation, can be configured in a setup.
Amber	Slow Blink	Device is not connected to the Wi-Fi network but attempting to reconnect.
Green/Amber	Alternating Blink	Device is in “Wireless Anywhere Companion Pairing Mode.”
Red	Blink	Wireless Anywhere Companion devices have unpaired or are at max number of paired devices.
Green/Red/Amber	Alternating Blink	identify feature triggered from the My Leviton App.

## SETUP MODE & FACTORY RESET

---

### SETUP MODE:

1. Hold the top rocker for 7 seconds.
2. After the first 7 seconds the status light will turn **Amber**, then release.
3. The status light will flash **Green**. The device is now in setup mode.

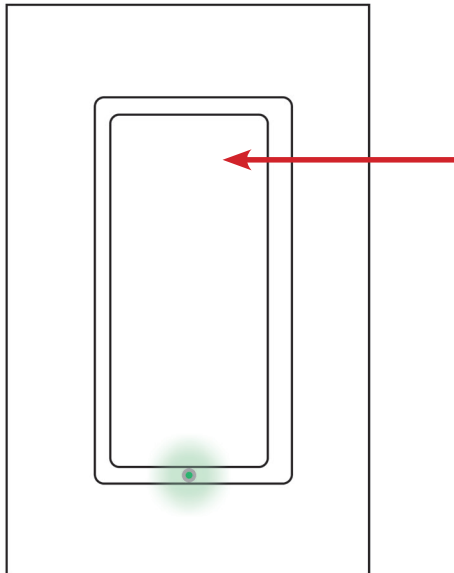

### FACTORY RESET:

1. Hold the top rocker for 14 seconds.
2. After the first 7 seconds the status light will turn **Amber**. Continue to hold.
3. After 7 more seconds, the status light will quickly flash **Red/Amber**.
4. Release the top rocker and the device will reset.

## TROUBLESHOOTING

---

Problem	Solution
Switch is wired and installed but the Feature does not respond.	Confirm that power has been restored at the circuit breaker.
	Verify wiring connections are correct.
When power is applied to the switch, the Feature is off and does not respond.	For proper operation the switch needs a line (hot), neutral, load, and ground connection.
	Confirm the white conductor is a neutral.
My Feature works, but my flame comes in and out.	Test Fire Feature with multimeter to make sure a line (hot) and neutral wire are connected.
Trouble connecting to Wi-Fi.	If your device is setup in the My Leviton App, select your device then select “Device Settings”. On the “Device Settings” screen select “Reconfigure Wireless”.  Then, follow the prompts to reconfigure your device and update the Wi-Fi settings.
How do I clean my Smart Switch?	Use a clean, damp cloth with mild soap. DO NOT use disinfecting products, including foggers, sprays or other types of atomized cleaning agents.



PROUDLY DESIGNED &  
MADE IN THE **USA**

 **THE OUTDOOR PLUS**  
USA MANUFACTURER OF FIRE & WATER PRODUCTS

701 S DUPONT AVE  
ONTARIO, CA 91761  
(909) 460 - 5579

[theoutdoorplus.com](http://theoutdoorplus.com)

